

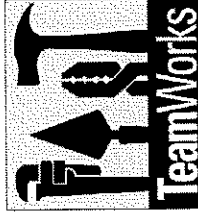

**SkillsUSA**  
Champions of Work®

2020 Carpenters Training Center  
75 Fieldcrest Ave. Edison, NJ 08837

Drawn By:



N.J. SkillsUSA

TeamWorks Committee

Drawing Issue:

\_\_\_\_\_  
\_\_\_\_\_  
\_\_\_\_\_

Scale: N.T.S

Drawing Number:

**R1.0**

Rafter Plan

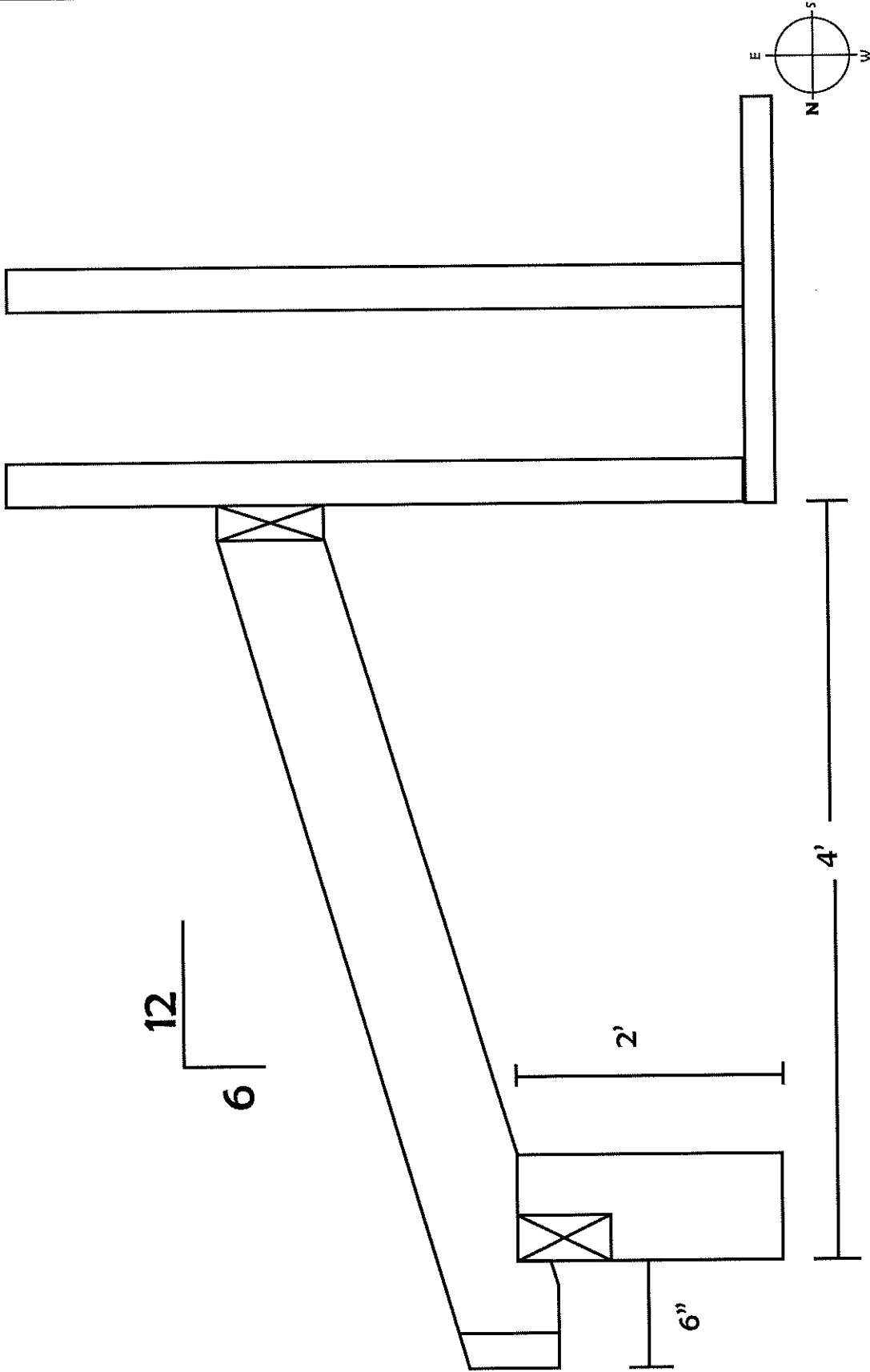

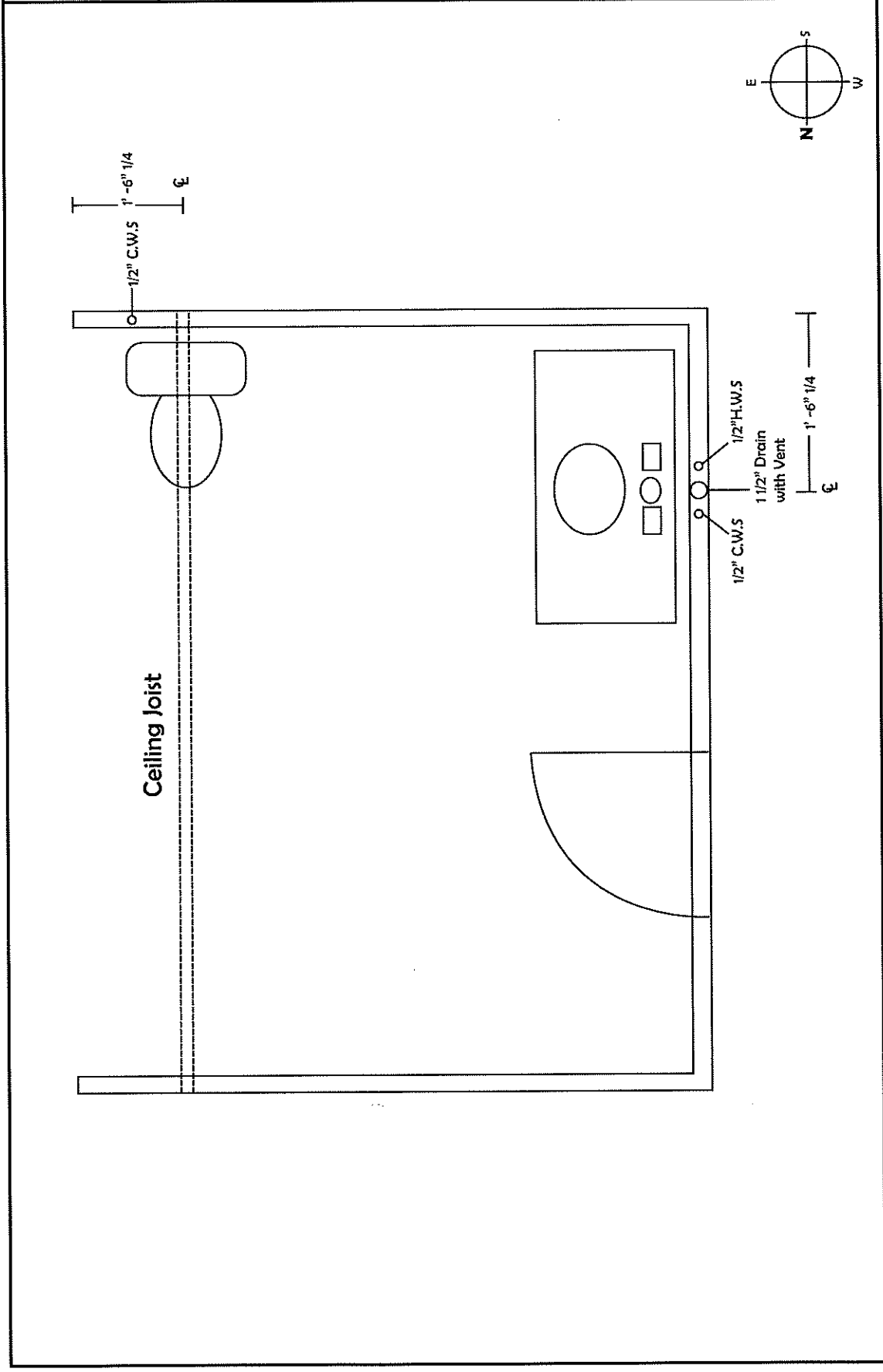

Drawing Issue:

---



---



---

Scale: N.T.S

Drawing Number:

**P1.0**  
 Plumbing Floor Plan

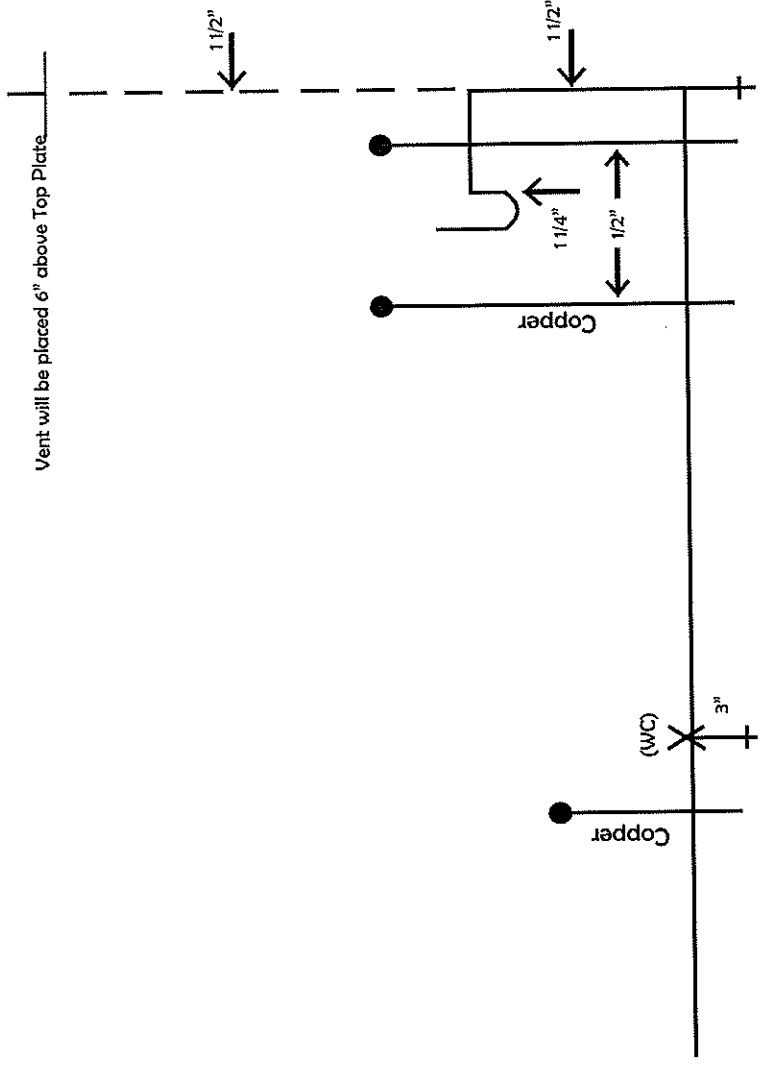

Vent will be placed 6" above Top Plate

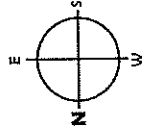

Notes - The following fixtures will be roughed in: (1) Water Closet (1) Lavatory Sink

- Water Closet (WC) must be roughed in at 12 1/2" from the back wall to the center of the WC. WC must be placed center of Powder Room. Toilet flange will be secured to plywood floor.

- Water Line for WC must be installed 6" to the left of the center of WC & must come through the bottom plate & terminate at 8" to center of water line. Water Line will stubbed into sub floor.

- Lavatory sink must be roughed in at 19" to center from plywood floor. Sink must be placed center of Powder Room. Drain line will be placed into sub floor.

- Water Lines for Lavatory must be placed at 21" to center, with spread of 8" center to center. Water Lines will be stubbed into sub floor.

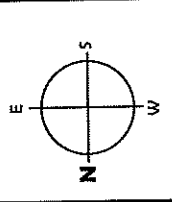
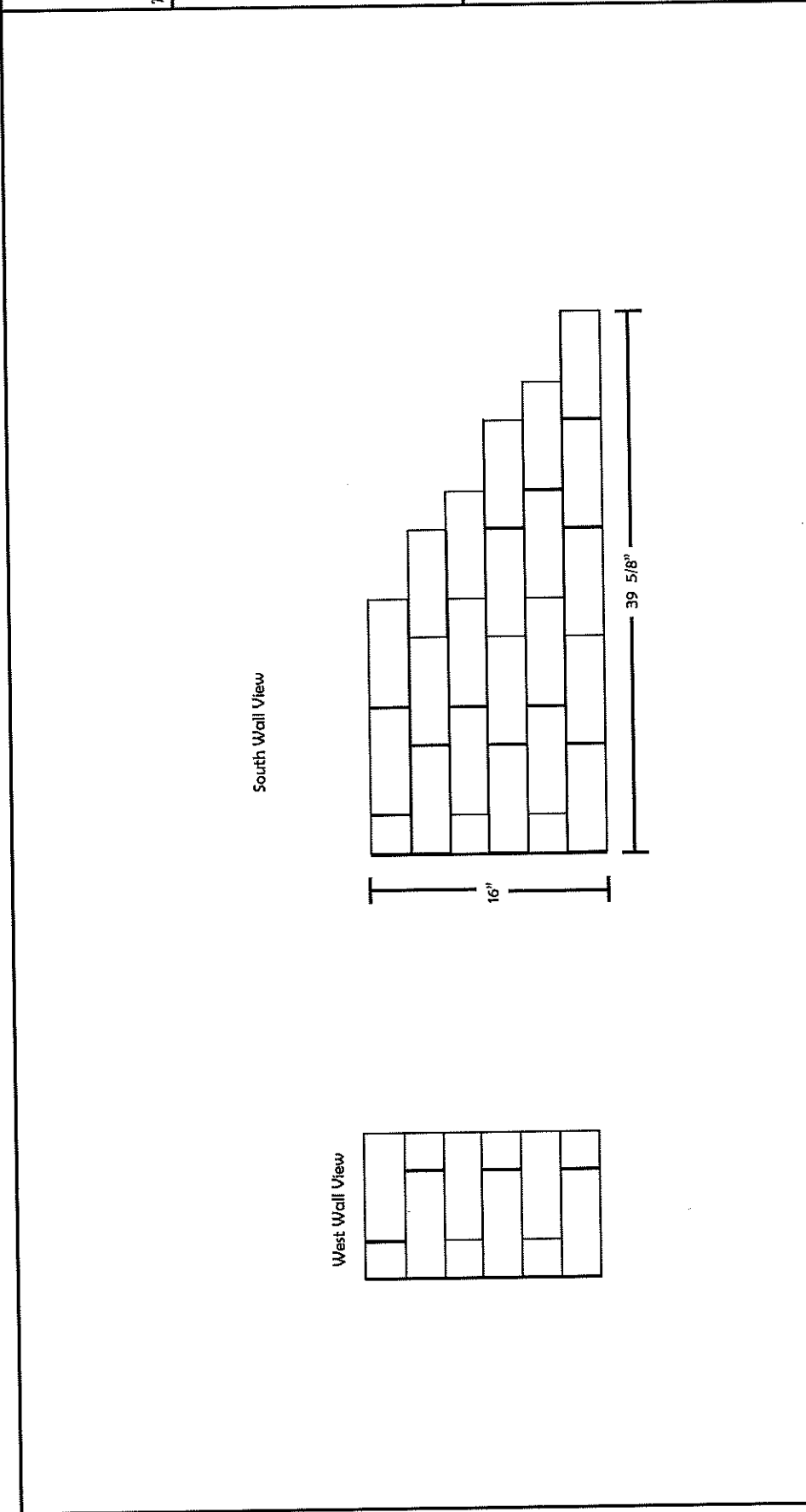

Notes: Standard Halflap design.  
 3/8" Joints



Champions at Work®  
 2020 Carpenters Training Center  
 75 Fieldcrest Ave. Edison, NJ 08837

Drawn By:

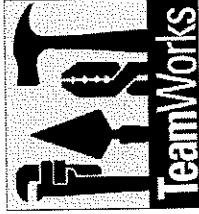

N.J. SkillsUSA  
 TeamWorks Committee

Drawing Issue:

\_\_\_\_\_  
 \_\_\_\_\_  
 \_\_\_\_\_

Scale: N.T.S

Drawing Number:

**E1.0**

Electrical Floor Plan

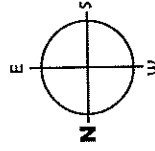
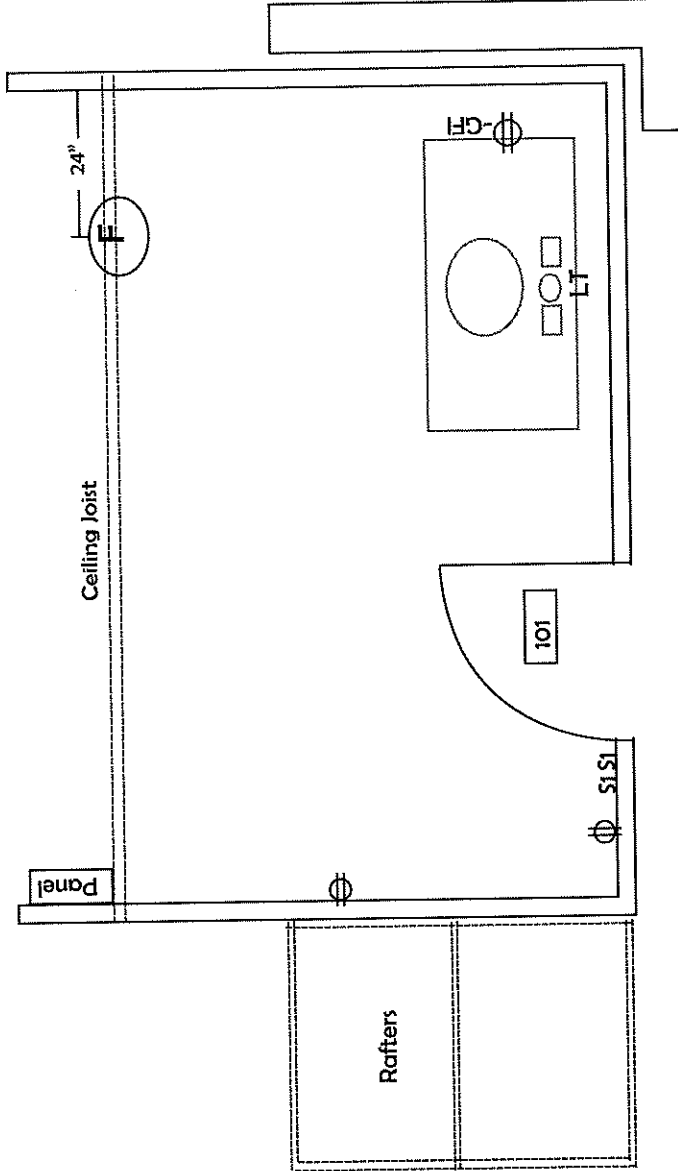

Panel Schedule	20 AMP- Bath	CFI	Notes:	Bath $\phi$ - 48" - Top
15 AMP-	$\phi$ 's		Bath S1- 48" - Top	
15 AMP-	Lighting		Light Fixture- 76" - Top	
			Panel- 68" - Top	
			General $\phi$ 18" - Top	

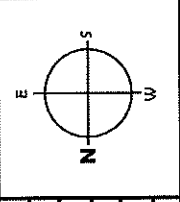
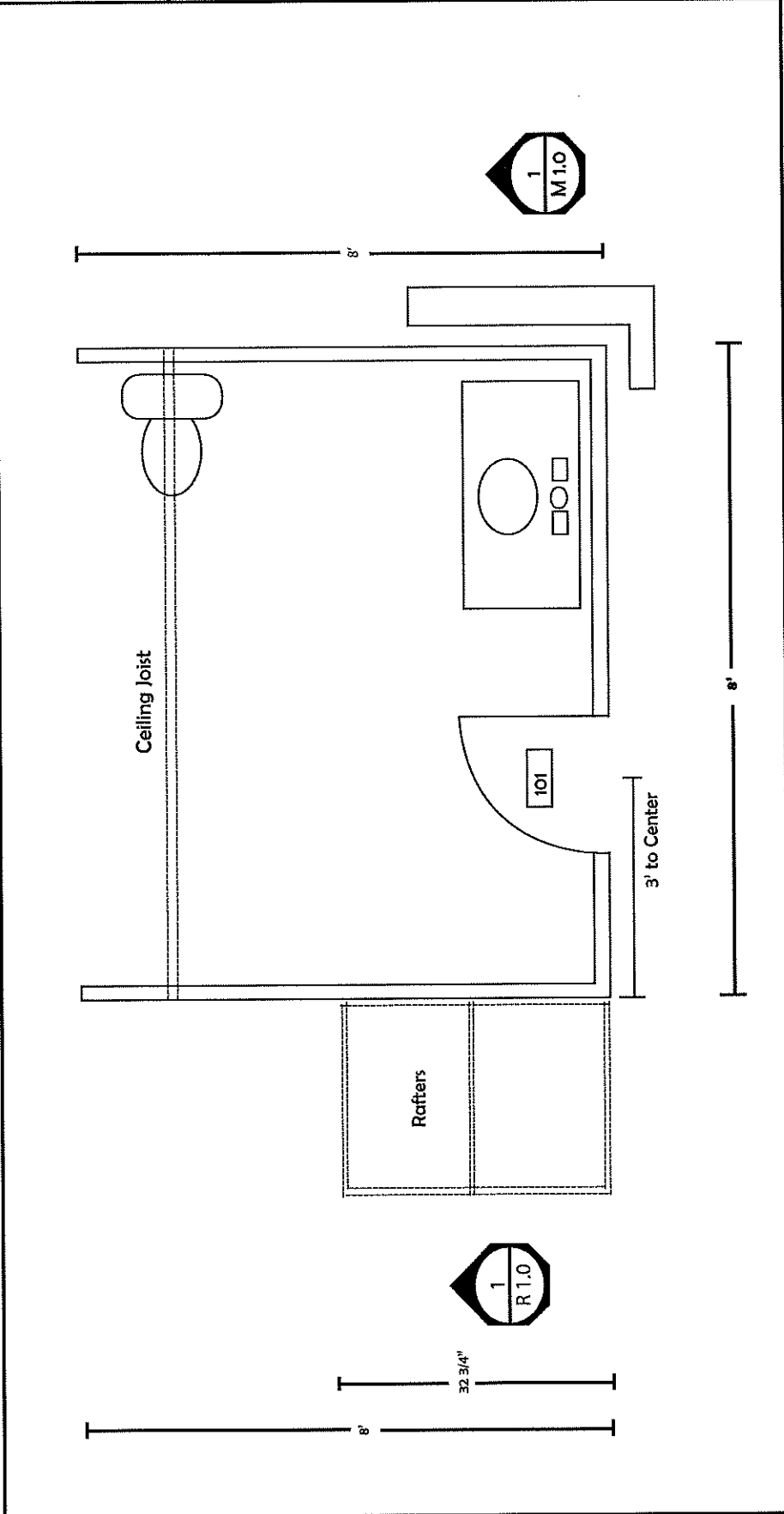

- Architectural Notes: Wall Height 8' 11/8"  
 Wall Framing 2X4  
 Rafters 2x6  
 Ridge 2X8  
 Conor Post to be framed using acceptable industry practice  
 Door Rough Opening 38" X 82"